

Index No.	Part Number	Part Name	Qty. Per Spec. No.		Index No.	Part Number	Part Name	Qty. Per Spec. No.	
			2827G9	2827G9-1				2827G9	2827G9-1
1	M13520G1	Shell, Upper	1	1	46	M14245	Air Line	1	-
1	M13520G3	Shell, Upper	-	1	(A)	M15970	Air Line	-	1
(A)	*M12864G1	Motor Package Assy	1	1	46	1000577	Grommet	-	1
2	M12811	Motor	1	1	47	M12828	Bracket, Shell Support	1	1
3	M8947	End Shield, front	1	1	48	1000577	Grommet	2	2
(B)	M15442G1	Pump and Filter Parts Package	1	1	49	M12829	Bracket, Motor Support	1	1
4	M11966-5	. Spring	1	1	50	**M10908-51	Screw, 10-24 x 1/2, Type S	1	1
5	M8643-3	. Blade	4	4	51	M12651	Clamp, Tinnerman	1	1
6	M11969	. Rotor	1	1	52	M12650-1	Capacitor	1	1
7	M8645-3	. Pump Bpdy	1	1	52A	1000576	Grommet (Photocell leads)	2	2
8	**FHPF3-7C	. Screw, Fil hd, 10-32 x 1/2 in.	2	2	53	M11271-6	Nut, Tinnerman	6	6
9	M12233	. End Cover, Pump	1	1	54	**M11084-27	Screw, 10-12 x 1/2 in., Type A	6	6
10	**WLI-3	. Washer	6	6	55	**M11084-27	Screw, 10-12 x 1/2 in., Type A	8	8
11	*M11637	. Filter, Lint	1	1	56	**M11084-29	Screw, 10-12 x 3/4 in., Type A	4	4
12	**M12461-34	. Screw, Hex hd, 10-32 x 1-1/2 in.	6	6	57	M5890	Grommet	1	-
13	*M12244G1	. Filter Assy	1	1	58	**M13942-4	Connector	2	2
14	*M12179	. Intake Filter	1	1		M13942-2	Connector	-	1
15	M12234	. End Cover	1	1	59	M10813G20	Extension Cord Assy	1	-
16	M10837	. Pipe Plug	1	1	59	M108BG1	Extension Cord Assy	-	1
(C)	M8943G2	. Pressure Relief Valve Assy	1	1	60	M9050	Adapter Grounding	1	1
17	M10362	.. Connector	1	1	61	M12826	Shell, Lower	1	-
18	M8940	.. Ball, 1/4 dia	1	1	61	M15810	Shell, Lower	-	1
19	M8941	.. Spring, Compression	1	1	62	**NTC-4C	Nut, Hex 1/4-20, Torque Lock	2	2
20	**M8993	.. Hex Nut, 3/8-24	1	1	63	**WPC-4C	Washer, 1/4 in.	2	2
21	M11941	.. Bushing, Pressure adjustment	1	1	64	M11084-27	Screw, 10-12 x 1/2, Type A	4	-
22	M12865	. Male Elbow	1	1	65	M12841G1	Mounting Bracket	1	-
23	**WLI-3	. Lockwasher, Internal #10	4	4	66	M6087	Grommet	1	-
24	**M12461-31	. Screw, Hex hd, 10-32 x 1 in.	4	4	67	M3259-4	Transformer (Note: when installing replacement, shorten leads as needed to fit inside)	1	-
25	M12934G1	Combustion Chamber	1	1	67	M15425	Transformer	-	1
(D)	*M12947G3	Burner Assy	1	1	68	M14985G1	Cover, Transformer	1	-
26	M14256	. Elbow	1	1	69	M12611	Thermostat	1	-
27	M12949	. Connector	1	1	69A	M16495	Thermostat Assy	-	1
28	**HF3-3C	. Screw, 10-32 x 3/8 in.	3	3	69B	M15814	Bracket, Thermostat	-	1
29	M12952	. Electrode RH	1	1	69C	**ST1-2B	Screw, Rd. hd., No. 6-32 x 1/4	-	4
30	M12951	. Electrode LH	1	1	70	**FHF3-3C	Screw, Fil hd, 10-24 x 3/8 in.	4	-
31	**WP-3C	. Washer, Flat	1	1	71	M11143-1	Bushing, Strain Relief	1	-
32	M14293	. Nozzle, Siphon	1	1	71	M11954	Bushing, Strain Relief	-	3
33	M10659-1	. Washer, Nozzle Seal	2	2	72	M10816G20	Lead, Electrode	2	2
34	M10809-1	. Spring, Nozzle Seal	1	1	73	M3353	Cap, Fuel Tank	1	1
35	M8882	. Sleeve	1	1	74	M14260	Bushing, Rubber	1	1
36	M12948G1	. Burner Head	1	1	75	M12820G4	Fuel Tank	1	1
37	M14259G1	Fuel Filter	1	1	76	M13990	Plug	1	1
38	No Number	Set screw, Socket hd, cup pt, 1/4-28	2	2	77	**M11084-27	Screw, 10-12 x 1/2 in., Type A	8	8
39	*M13038	Fan, 9° pitch	1	1	78	M15813-2	Handle, Front and Rear	2	2
40	M12830	Fan Housing	1	1	79	**M12345-33	Screw, Mach, oval hd, 10-24 x 1-3/4 in.	8	8
41	**NPC-4C	Nut	2	2	80	M12831-2	Frame, Support, wheel	1	1
42	**WLM-4	Lockwasher, 1/4 in.	2	2	81	**NTC-3C	Nut, 10-24	8	8
43	M10964-1	Clamp, Motor	4	4	82	M12867	Axle	1	1
44	M13620	Spacer	2	2	83	M14830	Wheel	2	2
45	**HC4-10C	Screw, 1/4-20 x 1-1/4	2	2	84	**WP-8C	Washer	2	2

(*) - Parts recommended for normal service replacement.
(**) - Standard hardware, obtainable locally.

MARK 120 DELUXE

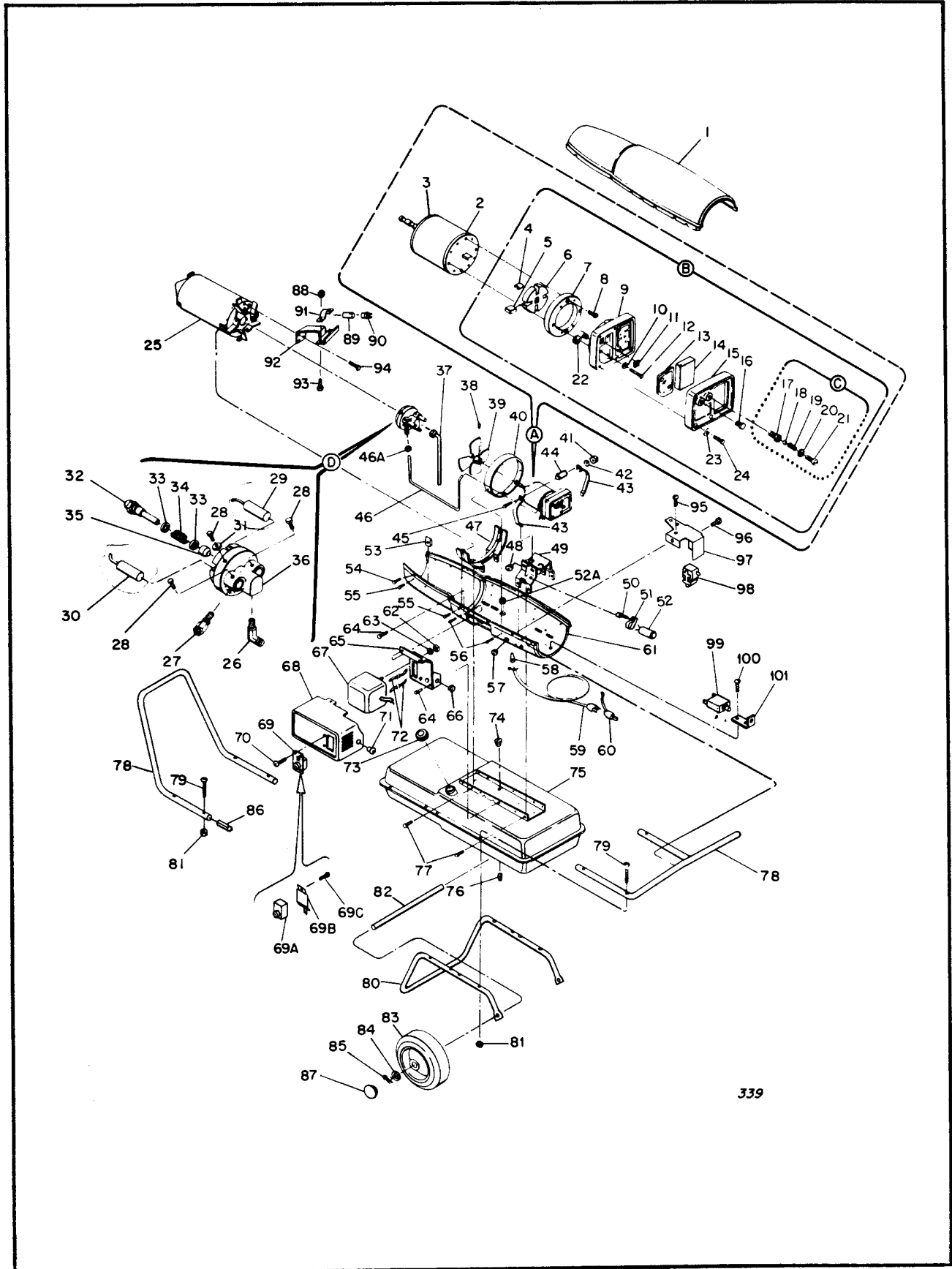

339

Figure 11. Mark 120 Deluxe Portable Heater; Exploded View

MARK 120 DELUXE

Index No.	Part Number	Part Name	Qty. Per Spec. No.		Index No.	Part Number	Part Name	Qty. Per Spec. No.	
			2827G9	2827G9-1				2827G9	2827G9-1
85	**C4-7	Cotter Pin	2	2					
86	M12336	Sleeve, Alignment	2	2					
87	M14831	Hub Cap	2	2					
<div style="display: flex; justify-content: center; gap: 20px;"> <div style="border: 1px solid black; width: 15px; height: 15px; margin: 0 auto;"></div> <div style="border: 1px solid black; width: 15px; height: 15px; margin: 0 auto;"></div> </div> <p>CONTROL AND ELECTRICAL PARTS</p>									
88	**NTC-1C	Locknut	2	2					
89	M13962	Tubing, Photocell	1	1					
90	M14456G1	Photocell and Bushing Assy	1	1					
91	M13963	Clamp, Tubing	1	1					
92	M13961	Bracket, Photocell	1	1					
93	**M12461-2	Screw, Hex hd, 6-32 x 3/8	2	2					
94	**M10908-1	Screw, Hex hd, No. 6-32 x 1/4, type "S"	2	2					
95	**ST2-2AC	Screw, Rd hd, No. 8 x 1/4	1	1					
96	**M12461-2	Screw, No. 6-32 x 3/8	1	1					
97	M14800	Bracket, Relay	1	1					
98	M14378G4	Relay Assy	1	1					
99	MA360	Circuit Breaker	1	1					
100	**M10908-14	Screw, No. 8-32 x 3/8, type "S"	1	1					
101	M14802	Bracket, Circuit Breaker	1	1					
	M9900G38	Wire Assy, Red, to circuit breaker	1	1					
	M9900G53	Wire Assy, Black, to circuit breaker	1	-					
						M9900G37	Wire Assy, Black, to circuit breaker	-	1
						M9900G51	Wire Assy, Black, to capacitor	1	1
						M16615G1	Wire Harness Assy, to photocell	1	1
						**M13942-2	Wire Connector	3	4
						M16007	Decal, Trade name	1	1
						M16023	Decal, Nameplate	1	-
						M16023-2	Decal, Nameplate	-	1
						M16613	Decal, Wiring diagram	1	1
						M12649	Decal, Operating instructions	1	-
						M15938	Decal, Operating instructions	-	1
						M14891	Decal, No-Fire Control	1	1
						M15407	Decal, AtoMaster	1	1
						M12647	Decal, Air Filter	1	1
						M16262	Decal, Caution	-	1
						M13272	Touch-Up Paint, Aerosol can, Light Gray		
						M13271	Touch-Up Paint, Aerosol can, Medium Gray		
						M13386-8	Touch-Up Paint, Aerosol can, Black		